

# PROJECT UPDATE

## Calexico West Land Port of Entry Expansion and Reconfiguration

*U.S. General Services Administration*

*March 16, 2017*

# Existing Calexico LPOE SITE

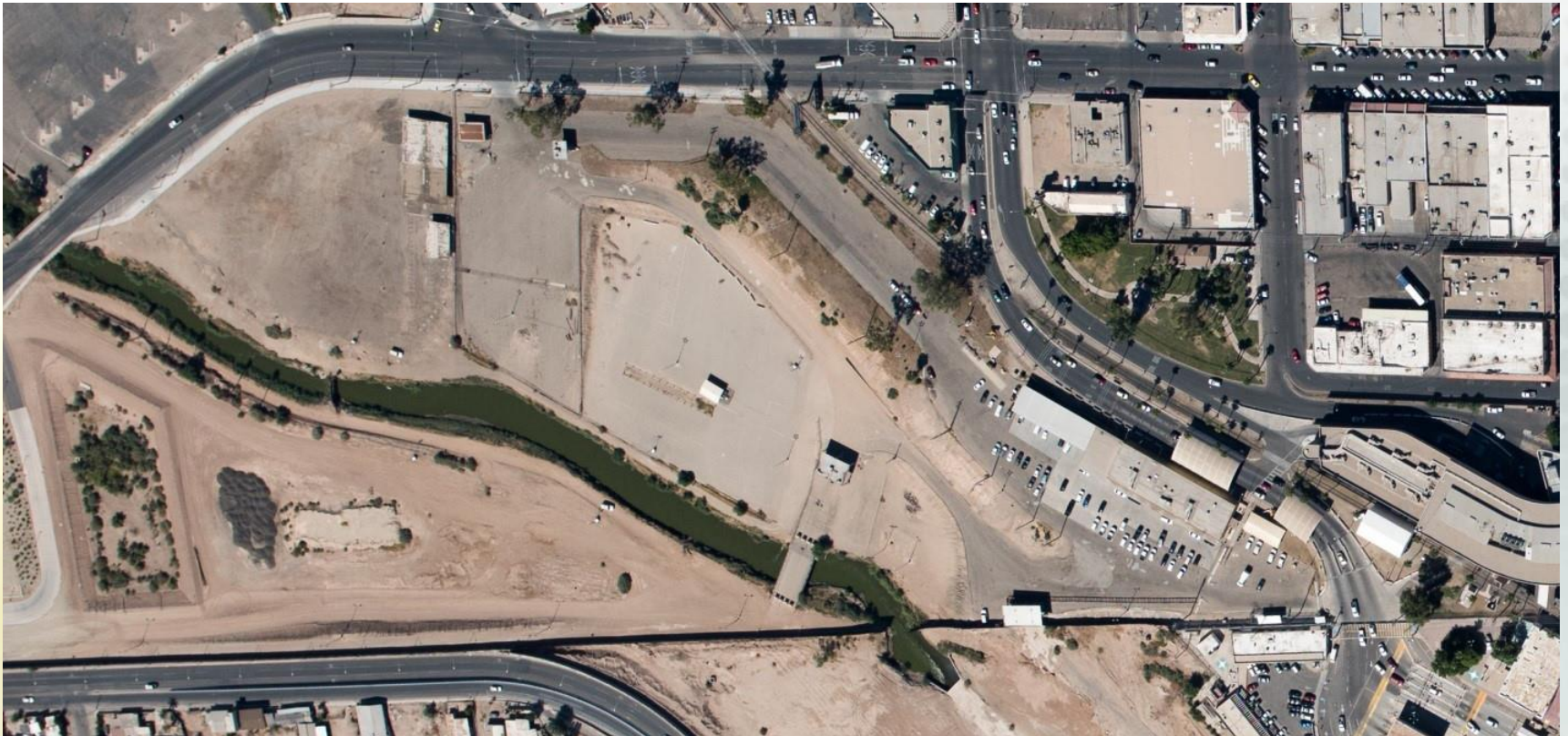

Aerial view of existing site as of September 2015

# Calexico LPOE (Phase 1 & 2)

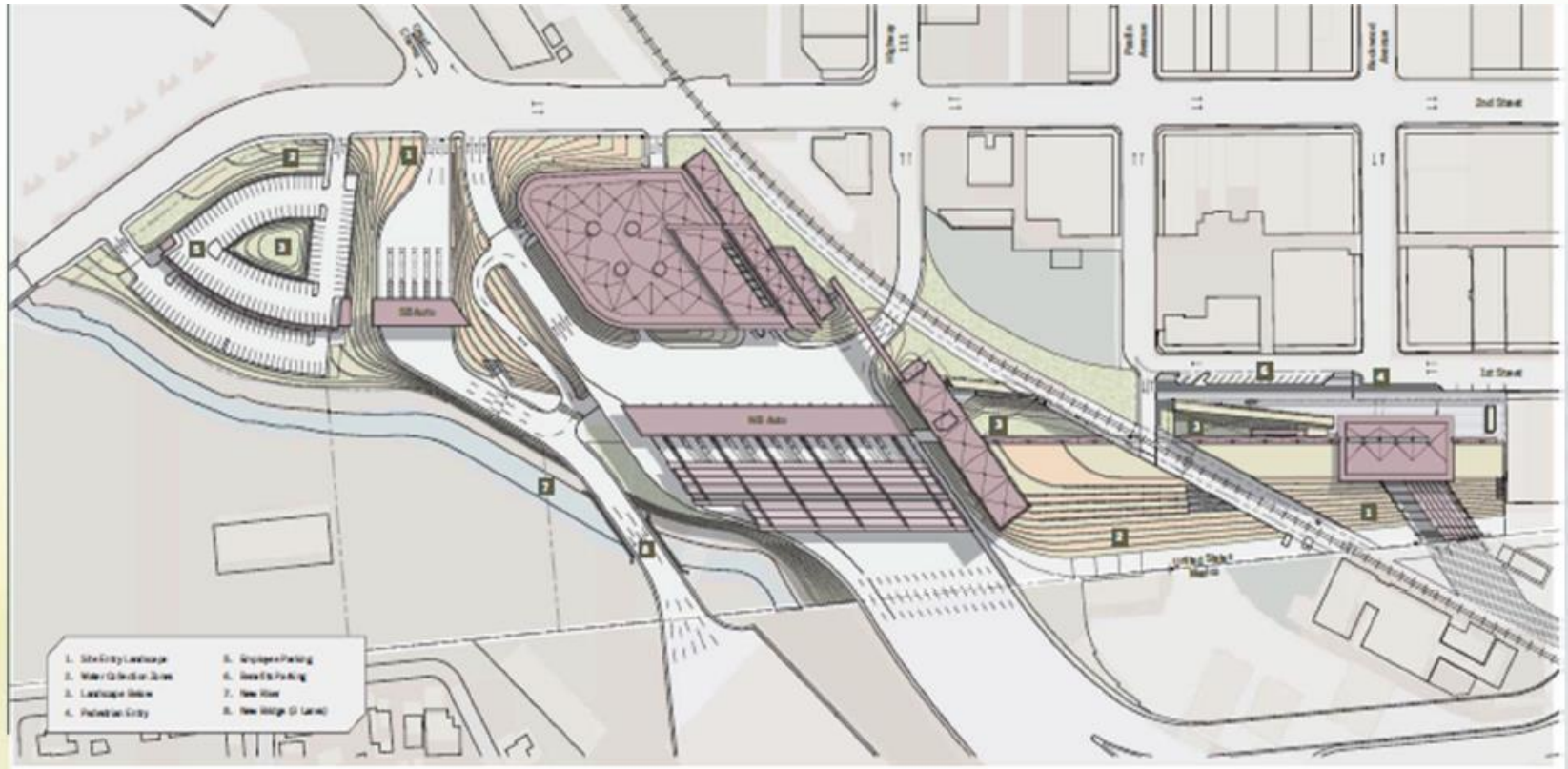

**Phase 1:** 10 NB POV lanes w/ primary & secondary canopies, new headhouse, 5 SB POV lanes  
**October 2015 – March 2018**

**Phase 2:** Demo exist Port building, build temp ped processing facility, new ped building, new admin building, 6 additional NB POV lanes, SB POV w/ canopies & booths  
**October 2017 – October 2020**



# Calexico LPOE FLY-OVER (Phase 1 & 2)

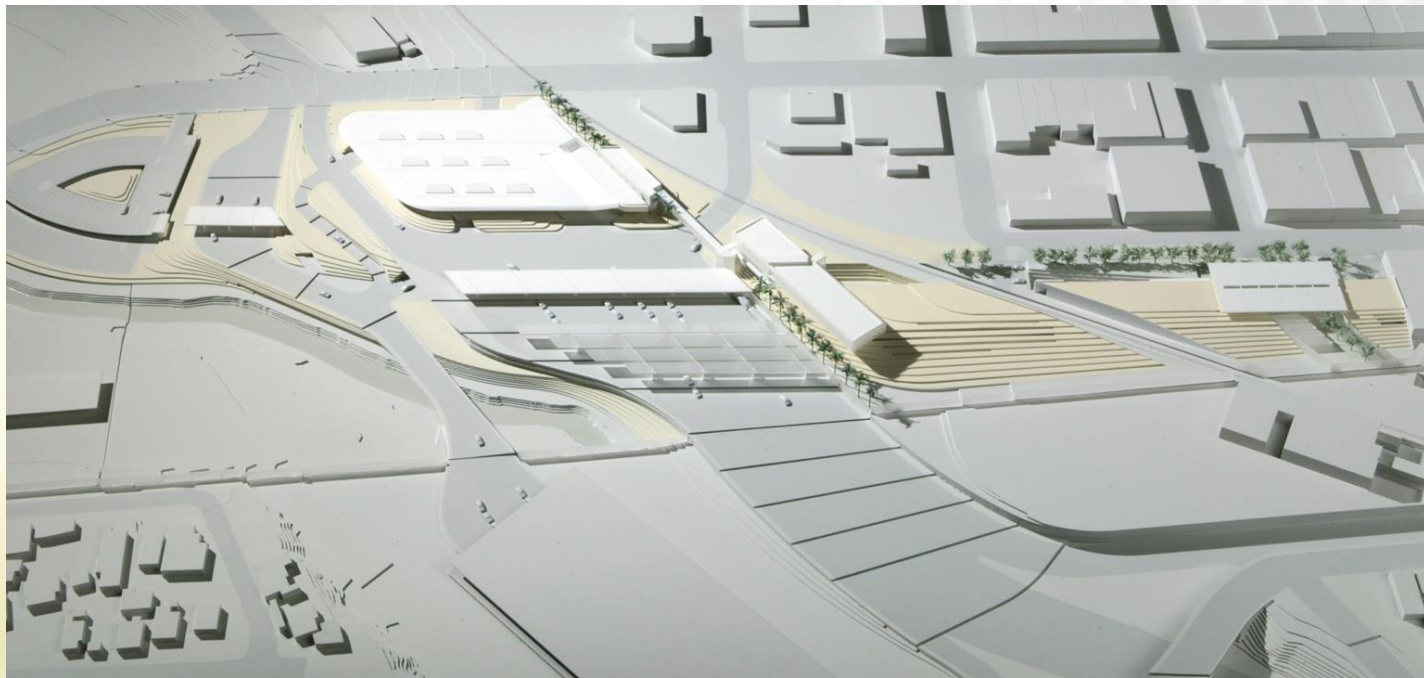

# Northbound POV / Admin Building



Looking north – approach from Mexico

## Pre-Primary Canopy



Looking north – pre primary canopy and primary canopy beyond



# Pedestrian Pavilion Entrance



Looking north – approach (pedestrian) from Mexico

## Pedestrian Pavilion from 1<sup>st</sup> St.



Looking west – pedestrians exiting to 1<sup>st</sup> St.



# Phase 1 Construction Progress



Aerial View as of January 24, 2017

# Phase 1 Construction Progress



Looking north – Shell Space structure



# Phase 1 Construction Progress



Looking south – concrete pour of Shell Space slab

# Phase 1 Construction Progress



Looking north – concrete pour of Northbound POV lanes



# Phase 1 Construction Progress



Looking north – northbound POV inspection

# Phase 1 Construction Progress



Looking north – new Headhouse



# Phase 1 Construction Progress



Looking south towards Mexico – Southbound POV across new bridge

# Phase 1 Construction Progress



60" Storm Drain Line Installation



## Upcoming Activities

Sewer line work across 2 <sup>nd</sup> St (off hours)	March-April 2017
2 <sup>nd</sup> St sidewalk	June –Aug 2017
Cesar Chavez/2 <sup>nd</sup> St. traffic signal (City)	July 2017 (estimated)
Temp ped processing facility & Demolition of existing Port building	Oct 2017 - March 2018
Phase 1 completion resulting in closure of existing Northbound / Southbound POV lanes	March 2018

# Calexico LPOE Temp Ped Processing

(expected completion March 2018)





# Calexico Phase 2



# Calexico LPOE Temp Ped Processing (expected completion March 2018)



SECURITY FENCE DIAGRAM

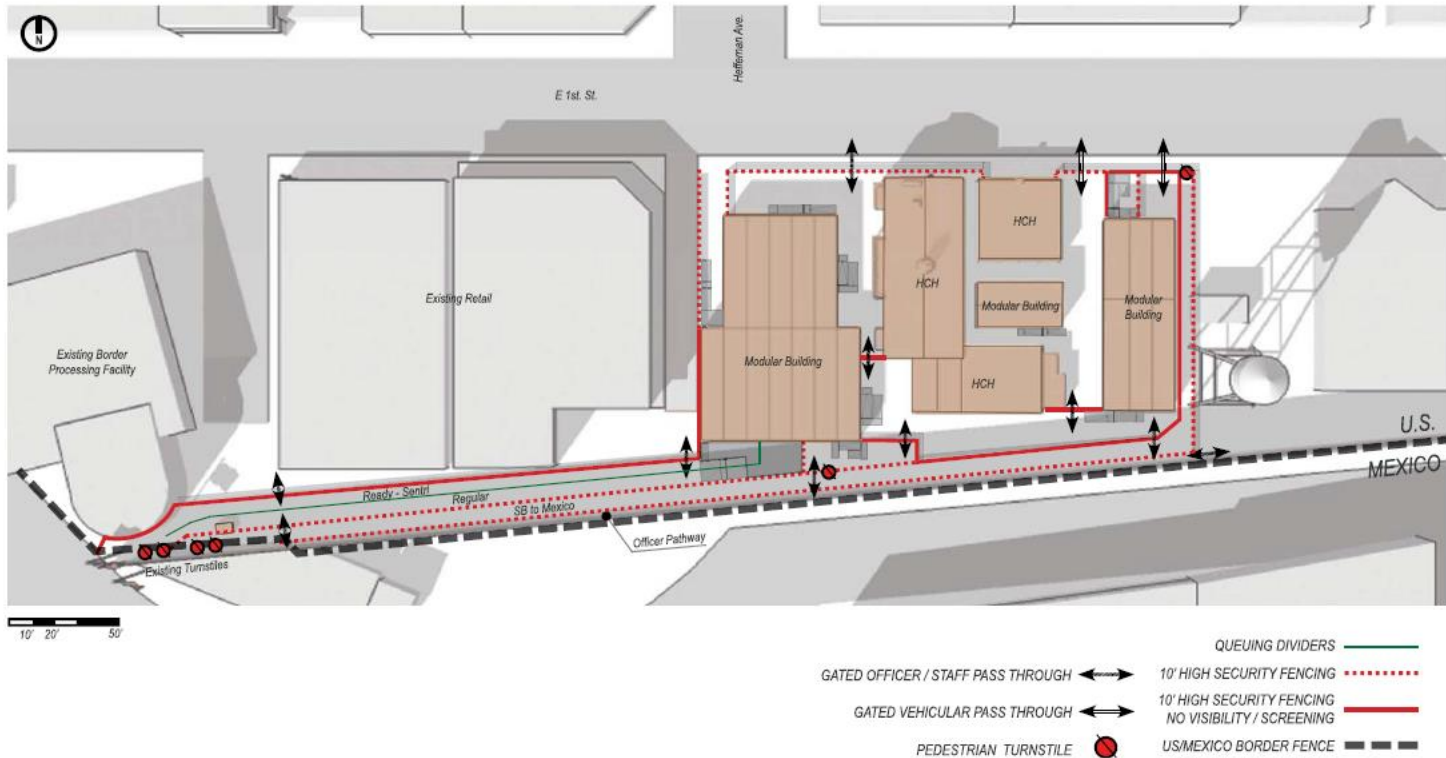

**CALEXICO TEMP. PEDESTRIAN PROCESSING FACILITY**

11.02.2016

WARNING: This document is FOR OFFICIAL USE ONLY (FOUO). It contains information that may be exempt from public release under the Freedom of Information Act (5 U.S.C. 552). It is to be controlled, stored, handled, transmitted, distributed, and disposed of in accordance with DHS policy relating to FOUO information and is not to be released to the public or other personnel who do not have a valid "need-to-know" without prior approval of an authorized DHS official.



## SHADING - PRE-PRIMARY INSPECTION

JULY 17TH @ 2:00PM

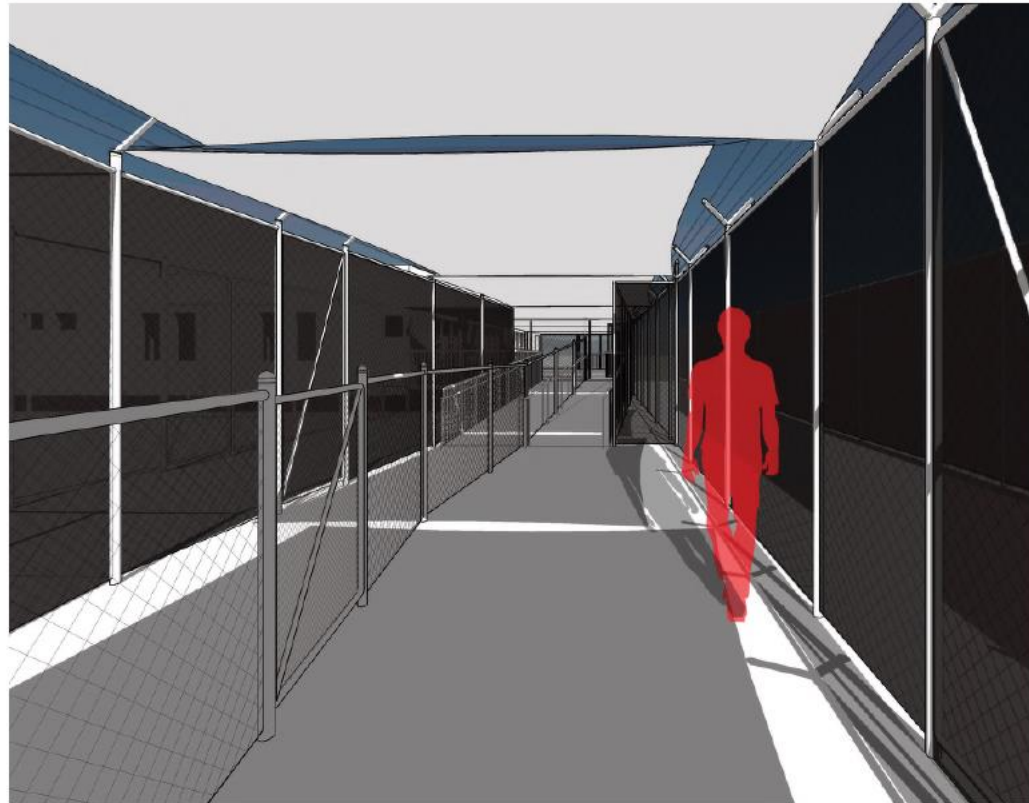

# Calexico LPOE Temp Ped Processing

(expected completion March 2018)





## *QUESTIONS*

**Ramón D. Riesgo**

U.S. General Services Administration

333 West Broadway, Suite 1001

San Diego, CA 92101-8843

Tel.: 619.557.5092

Fax: 619.557.7335

[ramon.riesgo@gsa.gov](mailto:ramon.riesgo@gsa.gov)

[www.gsa.gov](http://www.gsa.gov)